



Department for Levelling Up,  
Housing & Communities

Karen Mercer  
Programme Director  
Brent Cross Cricklewood Regeneration Scheme,  
London Borough of Barnet  
2 Bristol Avenue  
Colindale  
London  
NW9 4EW

Our Ref: HAPF/004/004/0014  
Your Ref:

3<sup>rd</sup> November 2021

Dear Ms Mercer,

**SECTION 19(2) OF THE LOCAL GOVERNMENT ACT 1985**  
**Appropriation of land at Brent Cross, Cricklewood (BXC), London**

1. Thank for your application of 23rd September 2021 and attached documents for the above consent.
2. In exercise of his powers under Section 19(2) of the Housing Act 1985 and after consultation with Regulator of Social Housing, the Secretary of State for Levelling Up, Housing and Communities hereby consents to London Brough of Barnet appropriating the land at Brent Cross, Cricklewood (BXC), London (shaded light and dark blue) on the attached site plan for planning purposes.
3. As a consequence, the above area which is no longer held for the purposes of Part II of the Housing Act 1985 need no longer be accounted for within the Housing Revenue Account.
4. The consent is numbered S19 - 2020/21-10. Please quote this reference, along with the reference above, in any future correspondence relating to this document.

Yours sincerely,

Victoria Latham  
**Deputy Director, Local Authority Housing**

Housing Revenue Account  
Department for Levelling Up, Housing and Communities  
3<sup>rd</sup> Floor, North East Quarter  
Fry Building  
2 Marsham Street  
London, SW1P 4DF

Tel 0303 444 3728  
Email: [Henry.Boye@communities.gsi.gov.uk](mailto:Henry.Boye@communities.gsi.gov.uk)

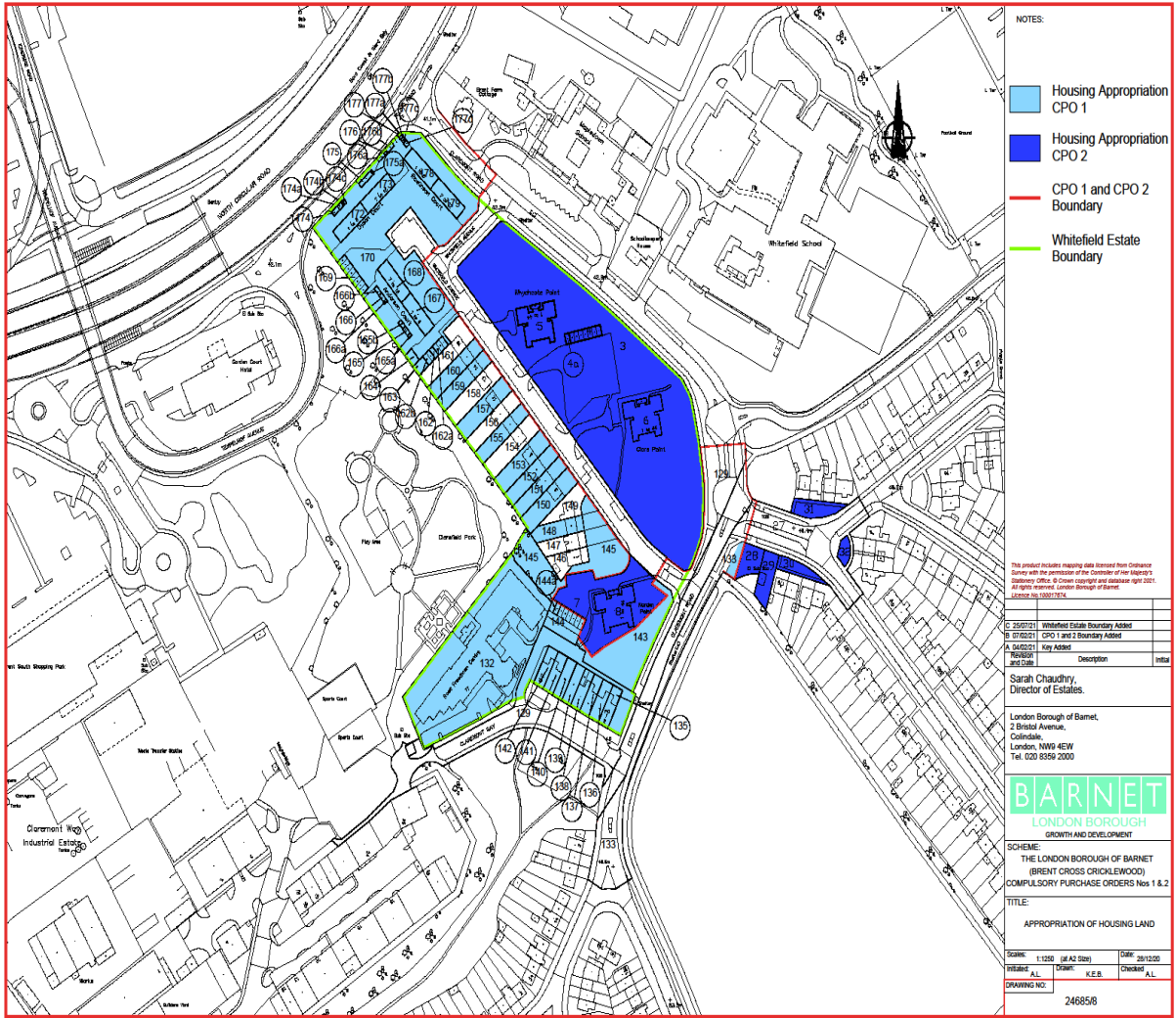

**NOTES:**

- Housing Appropriation CPO 1
- Housing Appropriation CPO 2
- CPO 1 and CPO 2 Boundary
- Whitefield Estate Boundary

This product includes mapping data licensed from Ordnance Survey with the permission of the Controller of Her Majesty's Stationery Office. © Crown copyright and database right 2021. All rights reserved. London Borough of Barnet. Licence No 100077674.

Symbol	Identified Estate Boundary Number
B (Dotted)	CPO 1 and 2 Boundary Added
A (Dotted)	Key Added
T (Dotted)	Revision
	Description
	Initial

Sarah Chaudhry,  
Director of Estates.

London Borough of Barnet,  
2 Bristol Avenue,  
Colindale,  
London, NW9 4EW  
Tel: 020 8359 2000

**BARNET**  
LONDON BOROUGH  
GROWTH AND DEVELOPMENT

SCHEME:  
THE LONDON BOROUGH OF BARNET  
(BRENT CROSS CRICKLEWOOD)  
COMPULSORY PURCHASE ORDERS Nos 1 & 2

TITLE:  
APPROPRIATION OF HOUSING LAND

Scale:	1:1000 (A2 Size)	Date:	28/10/20
Drawn:	AL	Checked:	AL
Drawn by:	K.E.B.	Checked by:	AL

DRAWING NO: 24685/8

Housing Revenue Account  
 Department for Levelling Up, Housing and Communities  
 3<sup>rd</sup> Floor, North East Quarter  
 Fry Building  
 2 Marsham Street  
 London, SW1P 4DF

Tel 0303 444 3728  
 Email: Henry.Boye@communities.gsi.gov.uk